

Gtech

ProLite

Model number: MM001

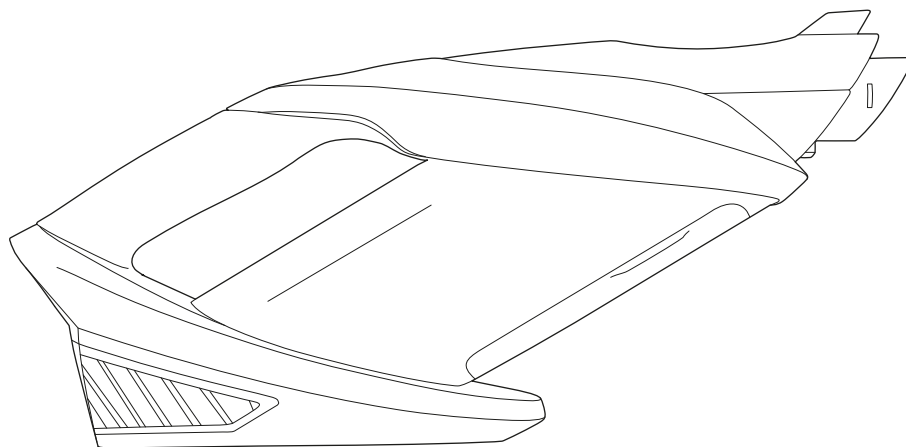

OPERATING MANUAL

IMPORTANT SAFEGUARDS:



IMPORTANT: READ ALL INSTRUCTIONS BEFORE USE. RETAIN INSTRUCTIONS FOR FUTURE REFERENCE.



Do not use in rain or leave outdoors whilst it's raining.



WARNING: basic safety precautions should always be observed when using an electrical appliance in order to reduce the risk of fire, electric shock or injury. These include the following:

Personal safety:

- Store indoors in a dry place out of the reach of children.
- Always use responsibly. This appliance can be used by children aged from 8 years and above and persons with reduced physical, sensory or mental capabilities or lack of experience and knowledge if they have been given supervision or instruction concerning use of the appliance in a safe way and understand the hazards involved.
- Don't let children play with the appliance; supervise children using or maintaining the appliance.
- Use only manufacturer's recommended attachments as described in this manual; misuse, or use of any accessory or attachment other than those recommended, may present a risk of personal injury.
- Take extra care when cleaning stairs.
- Keep the appliance and accessories away from hot surfaces.
- Do not block the appliance's openings or hinder airflow; keep openings free of any objects including dust, lint, clothing, fingers and all parts of the body.
- Keep hair, loose clothing, fingers and other body parts away from the brush bar and other moving parts.

Electrical safety:

- Only use batteries and chargers supplied by Gtech.
- Never modify the charger in any way.
- The charger has been designed for a specific voltage. Always check that the mains voltage is the same as that stated on the rating plate.
- A charger that is suitable for one type of

battery pack may create a risk of fire when used with another battery pack; never use the charger with another appliance or attempt to charge this product with another charger.

- Before use, check the charger cord for signs of damage or ageing. A damaged or entangled charger cord increases the risk of fire and electric shock.
- Do not abuse the charger cord.
- Never carry the charger by the cord.
- Do not pull the cord to disconnect it from a socket; grasp the plug and pull it to disconnect.
- Don't wrap the cord around the charger during storage.
- Keep the charger cord away from hot surfaces and sharp edges.
- The supply cord cannot be replaced. If the cord is damaged, the charger should be discarded and replaced.
- Do not handle the charger or the appliance with wet hands.
- Do not store or charge the appliance outdoors.
- The charger must be removed from the socket before removing the battery or cleaning or maintaining the appliance.
- Ensure the appliance is off before connecting or disconnecting the accessories and motorised brush bar.

Battery safety:

- This appliance includes Li-ion batteries; do not incinerate batteries or expose to high temperatures, as they may explode.
- Liquid ejected from the battery may cause irritation or burns.
- In an emergency situation, contact professional medical help immediately!

- Leaks from the battery cells can occur under extreme conditions. Do not touch any liquid that leaks from the battery. If the liquid gets on the skin, wash immediately with soap and water. If the liquid gets into the eyes, flush them immediately with clean water for a minimum of 10 minutes and seek medical attention. Wear gloves to handle the battery and dispose of it immediately in accordance with local regulations.
- Shorting the battery terminals may cause burns or fire.
- When the battery pack is not in use, keep it away from paper clips, coins, keys, nails, screws or other small metal objects that could make a connection from one terminal to another.
- When you dispose of the appliance, remove the battery and dispose of the battery safely in accordance with local regulations.

Service:

- **CAUTION** – to reduce the risk of injury from moving parts, remove the battery before servicing.
- Before using the appliance and after any impact, check for signs of wear or damage and repair as necessary.
- Do not use the appliance if any part is damaged or defective.
- Repairs should be carried out by a service agent or a suitably qualified person in accordance with relevant safety regulations. Repairs by unqualified persons could be dangerous.
- The product can be used for above floor cleaning and hard to reach places. Extra care should be taken when using the product for above floor cleaning.
- Never modify the appliance in any way, as this may increase the risk of personal injury.
- Only use replacement parts or accessories provided or recommended by Gtech.
- If the appliance is not working as it should, has been dropped, damaged, left outdoors, or dropped into water, return it to a service centre.

Intended use:

- This appliance has been designed for domestic dry vacuum cleaning only.
- Do not pick up liquids or use on wet surfaces.
- Do not pick up anything that is flammable, burning or smoking.
- Use only as described in this manual.
- Don't use on concrete, tarmac or other rough surfaces.
- The brush bar may damage certain floor surfaces. Before vacuuming flooring, rugs or carpets, check the flooring manufacturer's recommended cleaning instructions.
- This vacuum may damage delicate fabrics or upholstery. Care should be taken on loose weave fabrics or where there are loose threads. If in doubt, please test on an inconspicuous area first.
- The product has a constantly rotating brush bar. Never leave the cleaning head in one spot for an extended period of time, as this may damage the floor surface.

WARNING:

- **Do not use water, solvents or polishes to clean the outside of the appliance; wipe clean with a soft, dry cloth.**
- **Never immerse the unit in water and do not clean in a dishwasher.**
- **Only use authentic Gtech bags, batteries, charger etc.**
- **Do not use without a bag fitted.**
- **For household use only.**



Thank you for choosing Gtech

"Welcome to the Gtech family. I started Gtech to create sensible, easy to use products that do a great job, and hope you get many years of trouble-free performance from your new product."

Nick Grey – Inventor, owner of Gtech

Make a note of your product serial number for future reference. You can find this on the underside of the product.

____~
____~
____~
____~

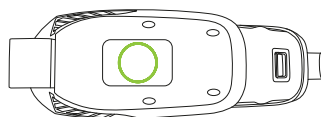

What's in the box

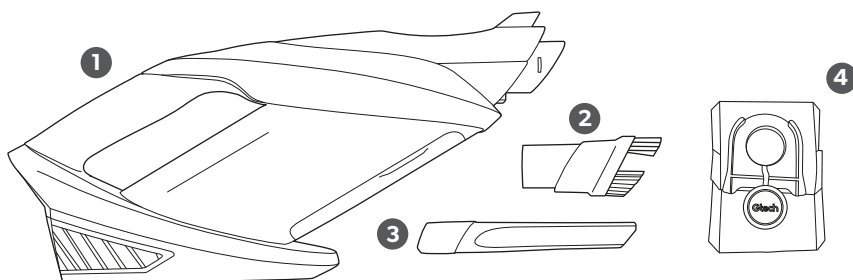

- 1 Main unit (bag fitted)**
- 2 Dusting brush**
- 3 Crevice tool**
- 4 Spare bags X2**
- 5 Battery (available separately)**
- 6 Charger (available separately)**

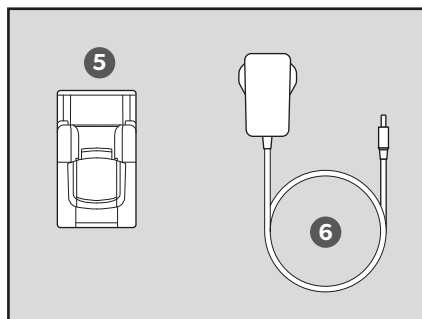

Tool configurations

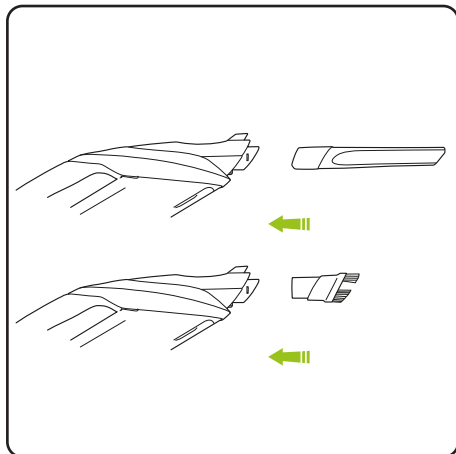

Your Pro Lite comes with a crevice tool and dusting brush as standard. Other tools are also available (see section at the back of this manual).

Operation

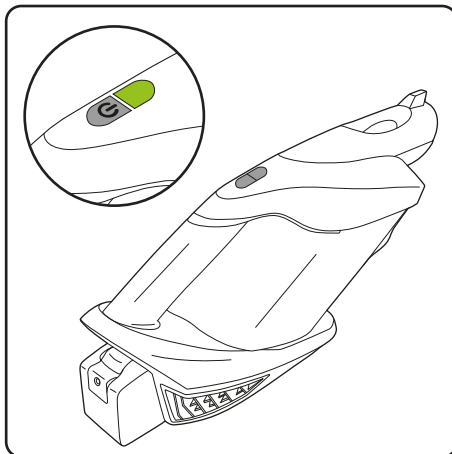

Press the power button above the handle to turn your vacuum on and off. It has a power symbol on it. Press the mode button above the handle to switch between 'Eco' and 'Max' mode.

LED headlights

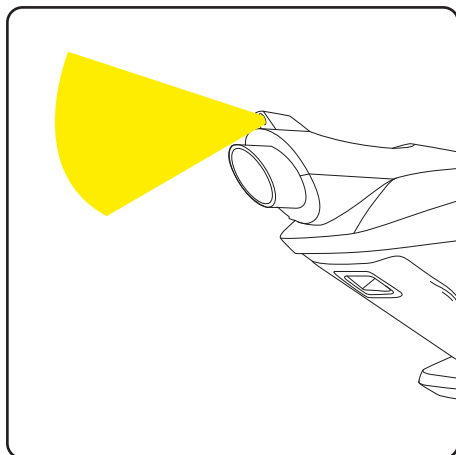

There is a LED headlight on top of the product to illuminate the area being cleaned.

Battery state of charge



The battery indicator shows how much charge remains in the battery.

Charging the battery

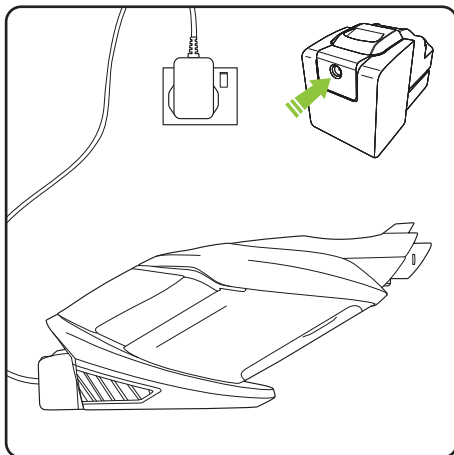

Connect the charger to the charging port located on the back of the battery pack. Plug the charger into the mains socket. You can charge the battery both on and off the product.

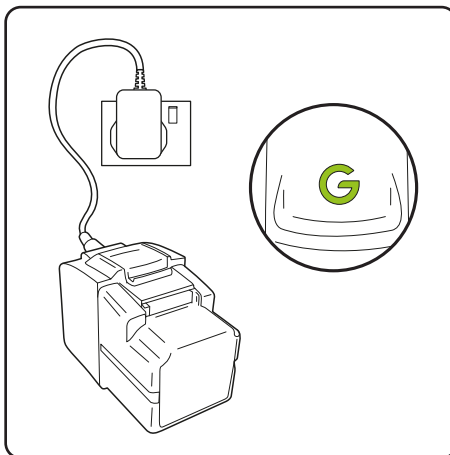

Whilst charging, the 'G' on the battery will pulsate green. Once the battery is fully charged, the indicator will show a solid green colour. This will take up to 2 hours from flat.

For a quick burst of cleaning, you can charge the battery for just 30 minutes.

Removing the battery

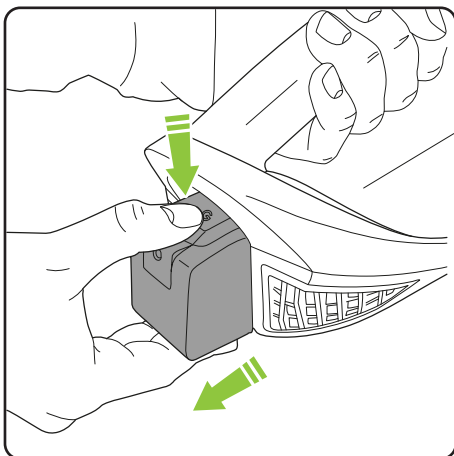

Press the latch on top of the battery downwards and slide it out of the product.

Replacing the battery

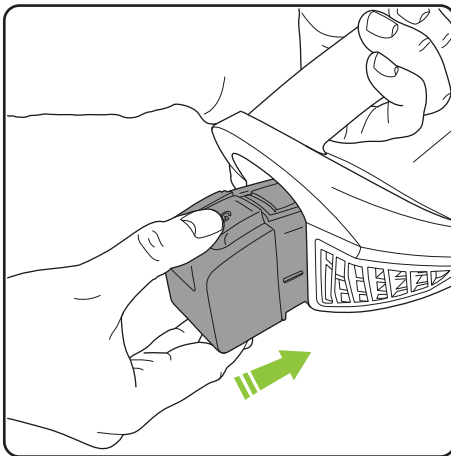

To refit the battery, simply slide it into the battery housing. Push the battery into the battery housing until it clicks into place.

If you want to buy a spare battery, go to www.gtech.co.uk/spares.

Bag removal

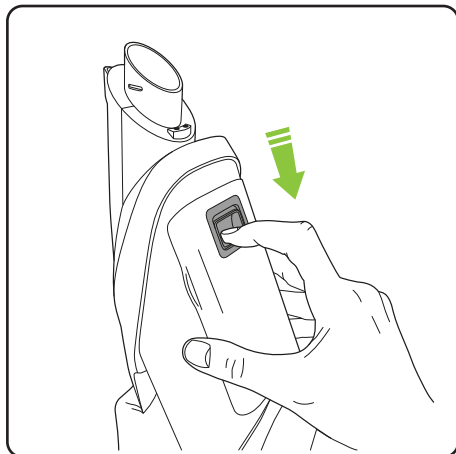

Unlock the bag chamber by sliding down the release latch located on the front of the product.

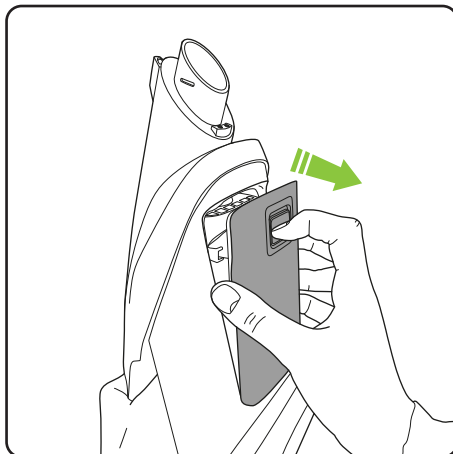

Pull the chamber cover away from the main unit.

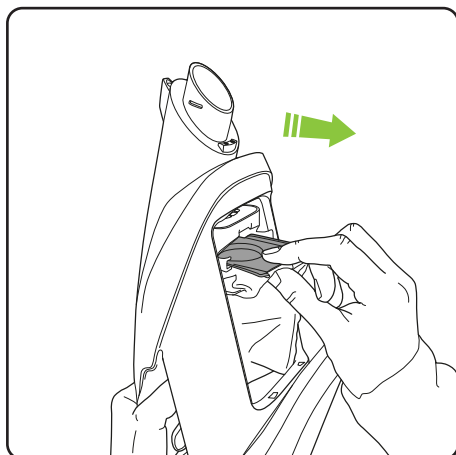

Slide the bag out of the bag chamber by gripping the collar of the bag.

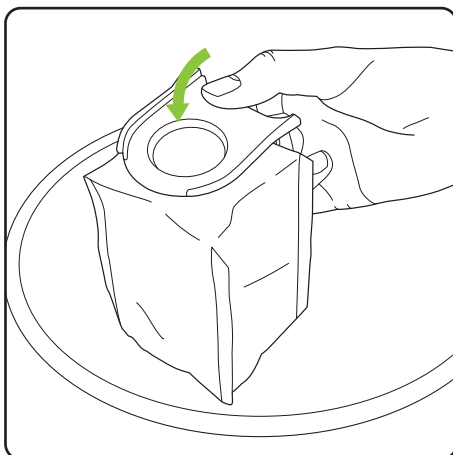

Cover the bag by folding over the lid. Dispose of the bag and replace with a new one. You can get more bags at:

www.gtech.co.uk/spares

or call 08081 685 028

Do not reuse bags as this could damage and reduce the performance of your Gtech product.

Bag installation

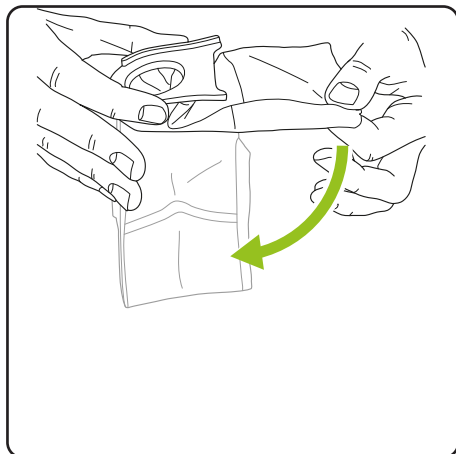

Before placing the bag in the chamber, ensure the bag is fully expanded by gently unfolding and spreading the fabric of the bag.

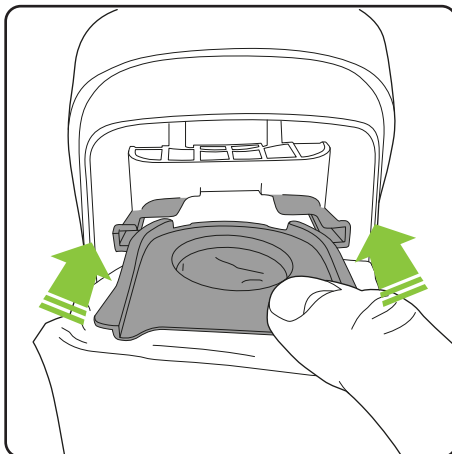

Slide the bag collar into the grooves inside the bag chamber. Make sure the collar is completely inserted into the chamber and the bag has expanded. A reduction in suction will occur if the bag has not expanded or is incorrectly fitted.

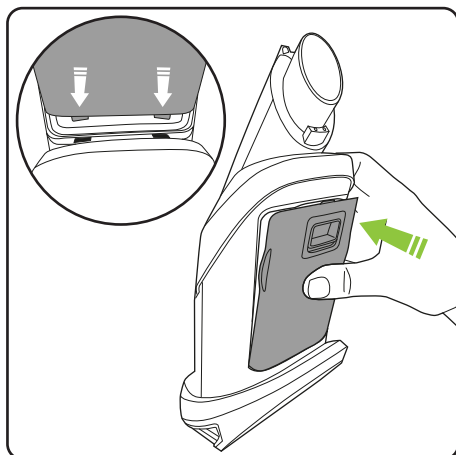

Refit the chamber cover. Fit the pegs on the cover into the slots at the bottom, then push the top part of the cover. You will hear a click when the cover is correctly fitted.

Do not use the vacuum without a bag; it may damage the motor and will invalidate your warranty.

Jams and blockages

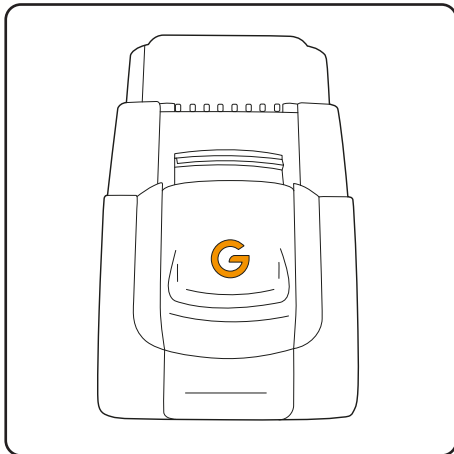

If the brush bar has jammed or there is a blockage, the battery will display a solid amber light for 5 seconds.

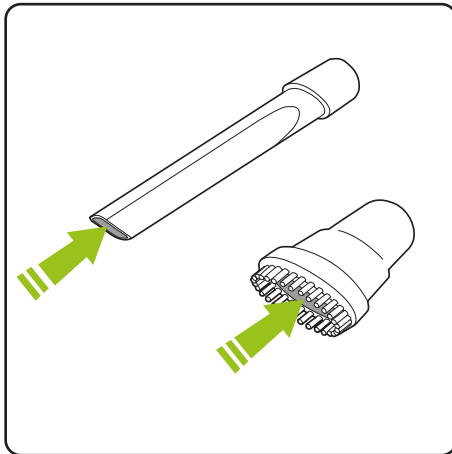

The tools can block sometimes too, so remove these from the main unit before checking for blockages.

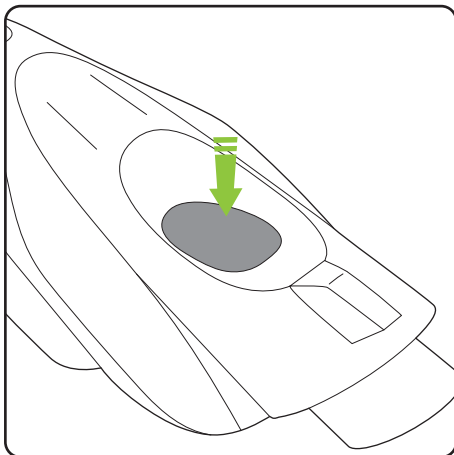

A light above the main unit's window allows you to check when the bag is full. You can also check for blockages.

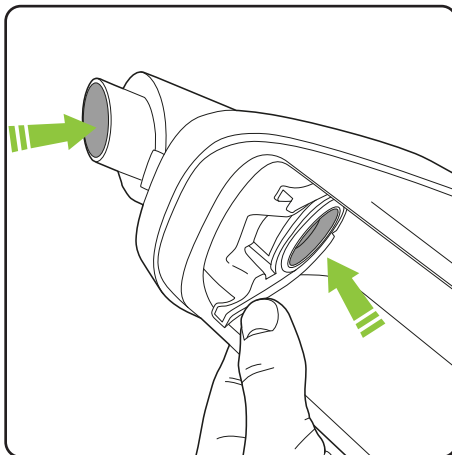

Remove the battery and bag and look through the nozzle. Remove any blockages.

If the bag is full or there is a blockage, there will be a reduction in suction.

Optional extras

Power brush

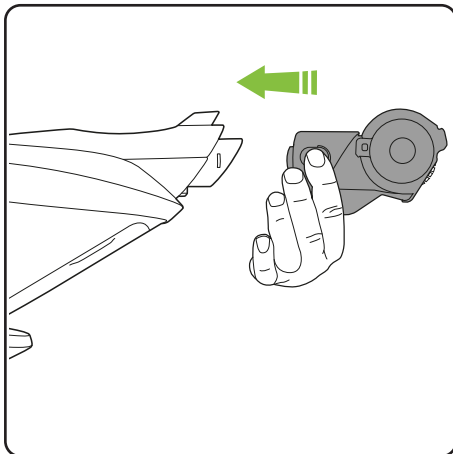

To attach the power brush, slot it over the standard nozzle. The power must be off while changing nozzles. To remove, place your fingers in the indents of the attachment, grip and pull it away from the main unit.

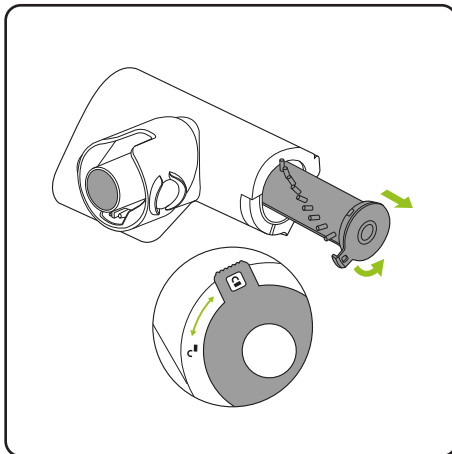

To clean the brush bar, first remove the power brush. Rotate the latch from the 'locked' to the 'unlocked' position and pull out the brush bar.

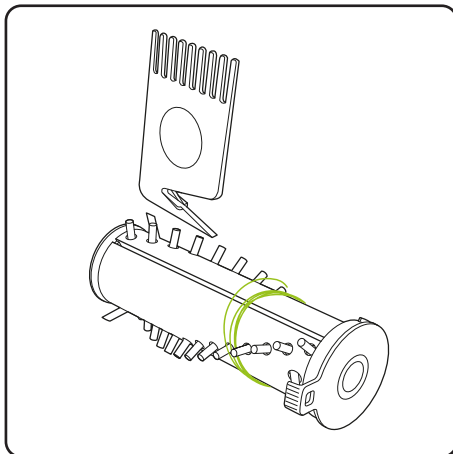

To remove hair from the brush bar, run the hair removal tool down the groove to cut the hair, then pull it out. Never operate the power head without the brush bar in.

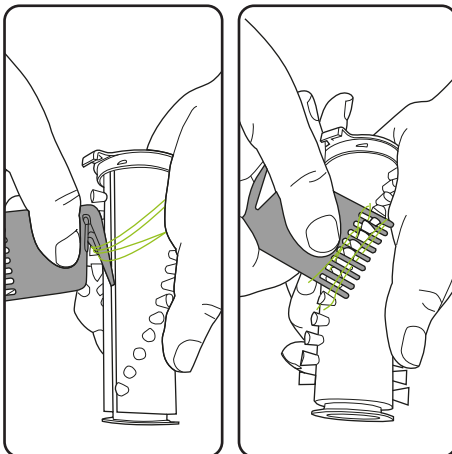

To remove hair from the brush bar, run the hair removal tool down the groove to cut the hair, then pull it out with the comb. Never operate the power head without the brush bar in.

Optional extras

Flexible power hose

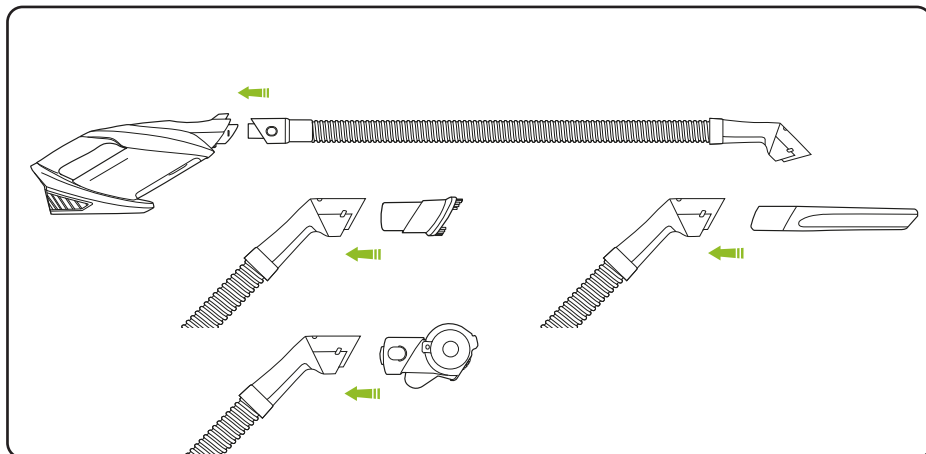

The flexible power hose attaches in the same way as the other accessories and can be used as it is or with the addition of other tools.

Optional extras

Wall mount

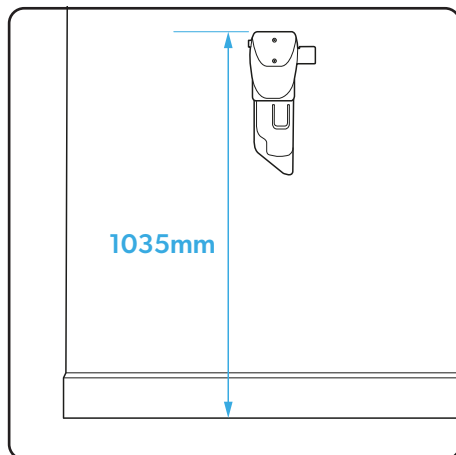

Install your wall mount at least 1035mm from the floor. Universal fixings have been included - please use the correct fixings for the wall type you're mounting this item to. Please use a stud finder to ensure no water pipes or electrical cables are hit. If you are unsure, please seek professional advice.

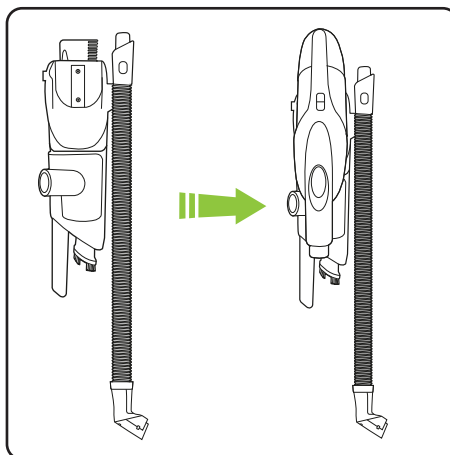

The tools can be stored like this on the wall mount. Your wall mount will look like the picture on the right when fully assembled with the ProLite.

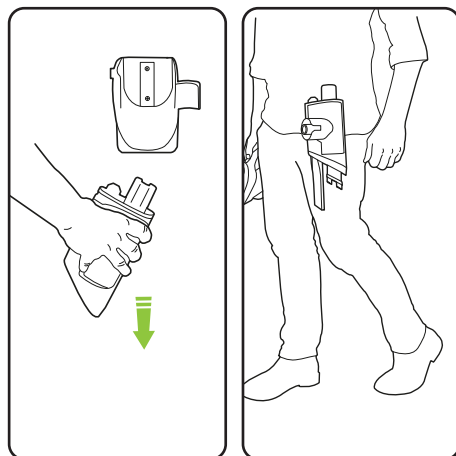

Pull the detachable tool kit out from the fixed section of the wall mount. You can also carry the detachable part of your wall mount with you while you clean - attach it to your belt. Extra precautions must be taken to ensure you do not damage the product or injure yourself.

Product care

Your product doesn't need much maintenance: check for blockages, remove hair from the brush bar and charge the battery. Wipe your vacuum with a soft, dry cloth if it gets dirty. Never wash it with liquid, run it under a tap or use it without a bag.

Troubleshooting

Product is not cleaning well	<ol style="list-style-type: none">1. Check for blockages.2. Replace the bag.3. Clean hair from the brush bar.4. Check the chamber cover is closed properly.
Product has stopped or won't work	<ol style="list-style-type: none">1. Charge the battery – check that the mains socket works and is switched on.2. Check for blockages.3. Check the battery is fully inserted.4. Check the battery is charged.
Battery will not charge	<ol style="list-style-type: none">1. Check the charger is correctly connected to the battery and mains supply.2. Check the mains socket works and is switched on.3. Try another plug socket.4. Check the charger cord for signs of wear or damage.
Amber light displayed on battery indicator for 5 seconds	<ol style="list-style-type: none">1. Brush bar jammed.2. Turn off the product, remove the battery and check for blockages.3. Clear any blockages.
Flashing amber light displayed on battery indicator	Charge the battery.
Red light displayed on battery indicator	Contact Gtech.

Product support

If these initial tips do not solve your problem we please visit our support area where you can find troubleshooting help including online manuals, FAQs and how-to-videos, as well as genuine spares and replacement parts compatible with your product.

Visit: www.gtech.co.uk/support



Online



Live chat support



support@gtech.co.uk



How to Videos

PRODUCT TECHNICAL SPECIFICATION

Battery model	165A0005
Battery	14.4V Li-Ion
Charging period	2 hours
Battery charger output	17.3v DC 1A
Weight (with standard nozzle)	0.9kg
Weight (full product)	2.1kg

The  symbol indicates that this product is covered by legislation for waste electrical and electronic products (2012/19/EU)

When the vacuum has reached the end of its life, it and the Li-ion battery it contains should not be disposed of with general household waste. The battery should be removed from the vacuum and both should be disposed of properly at a recognised recycling facility.

Call your local council, civic amenity site or recycling centre for information on the disposal and recycling of electrical products. Alternatively, visit www.recycle-more.co.uk for advice on recycling and to find your nearest recycling facilities.

FOR HOUSEHOLD USE ONLY



WARRANTY – REGISTRATION

Visit www.gtech.co.uk/warrantyregistration to register your product to ensure that we have all the information required to provide you with quick and efficient support.

You will need your product's serial code.

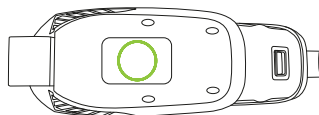

If you purchased directly from Gtech, your details are already registered and your 2-year warranty will start automatically.

If you purchased from an authorised Gtech retailer, please register your warranty within 3 months. You will need to provide proof of purchase to support any claim(s) against your warranty.

WARRANTY – TERMS AND CONDITIONS

If your product is within its warranty and has a fault that cannot be resolved from the troubleshooting section or online support, please do the following:

- Contact our Gtech Customer Care Helpline on UK: 08000 308 794, who will go through any troubleshooting with you to identify the fault.
- If your fault can be resolved by a replacement part, this will be sent to you free of charge.
- Following troubleshooting, if your product needs to be replaced, we will arrange collection of your faulty product for inspection, and delivery of a replacement product free of charge.

Your product is guaranteed against material or manufacturing faults for 2 years from the date of purchase (or the delivery date if this is later) subject to the following terms and conditions:

SUMMARY

The guarantee becomes effective at the date of purchase (or the date of delivery if this is later). If a product is repaired or replaced during the warranty period, the warranty period is not started again.

- You must provide proof of delivery/purchase before any work can be carried out on the product. Without this proof, any work carried out will be chargeable. Please keep your receipt or delivery note.
- All work will be carried out by Gtech or its authorised agents.
- Any parts which are replaced will become the property of Gtech.
- The repair or replacement of your product is under guarantee and will not extend the period of guarantee.
- The guarantee provides benefits which are additional to and do not affect your statutory rights as a consumer.

WHAT ISN'T COVERED

Gtech does not guarantee the repair or replacement of a product as a result of:

- Normal wear and tear (e.g. drive belt, brush bar, batteries).
- Use of consumables (e.g. dust bags and cartridges)
- Accidental damage, faults caused by negligent use or lack of care and maintenance, misuse, neglect, careless operation or handling of the product which is not in accordance with operating manual.
- Blockages. Please refer to the operating manual for details of how to unblock your product.
- Use of the product for anything other than the normal domestic household purposes.
- Use of parts and accessories which are not Gtech genuine components.
- Faulty installation (except where installed by Gtech)
- If it is modified in any way.
- Repairs or alterations carried out by parties other than Gtech or its authorised agents.
- Purchasing your product from an unofficial third party (i.e. not from Gtech or an official Gtech retailer).
- If you are in doubt as to what is covered by your guarantee, please call the Gtech Customer Care Helpline on UK: 08000 308 794

International orders are subject to a delivery charge for both faulty and non faulty products.



Grey Technology Limited

Brindley Road, Warndon, Worcester WR4 9FB

email: support@gtech.co.uk

telephone: 08000 308 794

www.gtech.co.uk

CPN4703