

Task Light

Model number: CTL002

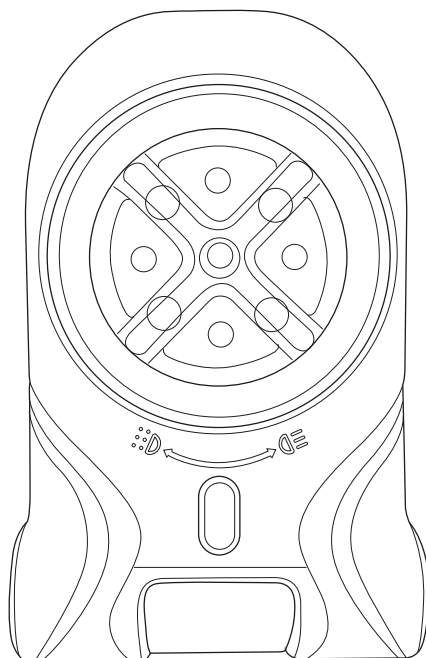

OPERATING MANUAL

IMPORTANT SAFEGUARDS:



**IMPORTANT: READ ALL INSTRUCTIONS BEFORE USE.
RETAIN INSTRUCTIONS FOR FUTURE REFERENCE.**



WARNING: Basic safety precautions should always be observed when using an electrical appliance to reduce the risk of fire, electrical shock or serious injury.

Personal Safety:

- Do not look directly at the light source or direct the light at your eyes.
- The product should not be positioned whereby it can be stared into for a prolonged period at a distance of less than 2.9m.
- Never operate the product if it is damaged.
- Keep the product and all accessories away from hot surfaces.
- Never modify the product in any way.

Electrical safety:

- Only use batteries and chargers supplied by Gtech.
- Never modify the charger in any way.
- The charger has been designed for a specific voltage. Always check that the mains voltage is the same as that stated on the rating plate.
- A charger that is suitable for one type of battery pack may create a risk of fire when used with another battery pack; never use the charger with another appliance or attempt to charge this product with another charger.
- A damaged or entangled charger cord increases the risk of fire and electric shock.
- Do not abuse the charger cord.
- Never carry the charger by the cord.
- Do not pull the cord to disconnect from a socket; grasp the plug and pull to disconnect.
- Don't wrap the cord around the charger to store.
- Keep the charger cord away from hot

surfaces and sharp edges.

- The supply cord cannot be replaced. If the cord is damaged the charger should be discarded and replaced.
- Avoid body contact with earthed or grounded surfaces, such as pipes. There is an increased risk of electric shock if your body is earthed or grounded.
- Do not handle the charger or product with wet hands.
- Do not let children use or charge the product.
- Ensure users have an understanding of how to use, maintain and charge the product.
- Do not charge the battery pack outside.
- Before charging check the power supply and charger cables for signs of damage or ageing.

Battery and charger use and care:

- This appliance includes Li-Ion batteries; do not incinerate batteries or expose to high temperatures, as they may explode.
- Only use batteries that are recommended for this tool by the manufacturer. Use of any other battery may cause risk of injury or fire.
- When the battery is not in use, keep it away from metal objects that could connect one terminal to another. If the terminals are connected the battery could cause fire or burns.
- Keep the battery free of abusive situations, if a battery is damaged it can eject battery liquid. If you encounter the

battery liquid flush the contact area with water. If your eye encounters the battery liquid flush with water and seek medical help. Battery liquid can cause irritation or burns.

- In an emergency situation contact professional help immediately!
- Only charge the battery with a charger recommended by the manufacturer. Use of any other charger may cause risk of injury or fire.
- Do not use chargers for anything other than charging manufacturer recommended batteries, otherwise electric shock could occur.
- Do not expose the charger to rain or snow. Make sure the charger's cord is in an area where it will not be damaged.
- Extension cords should not be used unless necessary. Improper use of an extension cord can result in electric shock.
- Do not place an object on top of the charger. This could block ventilation slots and cause excessive internal heat.
- Do not use the charger if it has been subjected to a hard blow, has been dropped, or damaged otherwise. Take the charger to an authorized repair centre.
- Do not disassemble the charger. If the charger needs to be repaired take it to an authorized repair centre.
- Before cleaning the charger make sure to unplug it from any power source. This will reduce the risk of an electrical shock.
- Store the battery away from any liquids and chemicals that may damage the battery and cause a risk of fire.
- Store the battery in clean, dry conditions, within a recommended temperature range of 0 - 25°C
- Do not store the battery in areas of high temperature above 25°C. Do not store near a source of heat or where exposed to direct sunlight. Do not store in areas

that can reach high temperatures such as outside sheds or metal buildings in the summer.

- When you dispose of the appliance remove the battery and dispose of the battery safely in accordance with local regulations.

Maintenance and storage

- Use only the manufacturer's recommended replacement parts and accessories.
- When not in use, store out of the reach of children.
- The LEDs of the product are not replaceable; when they reach the end of life the product must be replaced.

Intended Use:

- **This product is intended for DOMESTIC USE ONLY.**

WARNING:

- **Do not use solvents, or polishes to clean the outside of the appliance; wipe clean with a dry cloth.**



Thank you for choosing Gtech

"Welcome to the Gtech family. I started Gtech to create sensible, easy to use products that do a great job, and hope you get many years of trouble-free performance from your new product."

Nick

Nick Grey – Inventor, owner of Gtech

Make a note of your product serial number code for future reference. You can find this on the underside of the product once the battery has been removed.

____~
____~
____~
____~

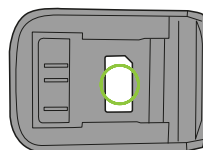

About your product

- 1 Power switch
- 2 Lens/Adjuster
- 3 Hanging hook
- 4 Magnet
- 5 Battery*
- 6 Charger*

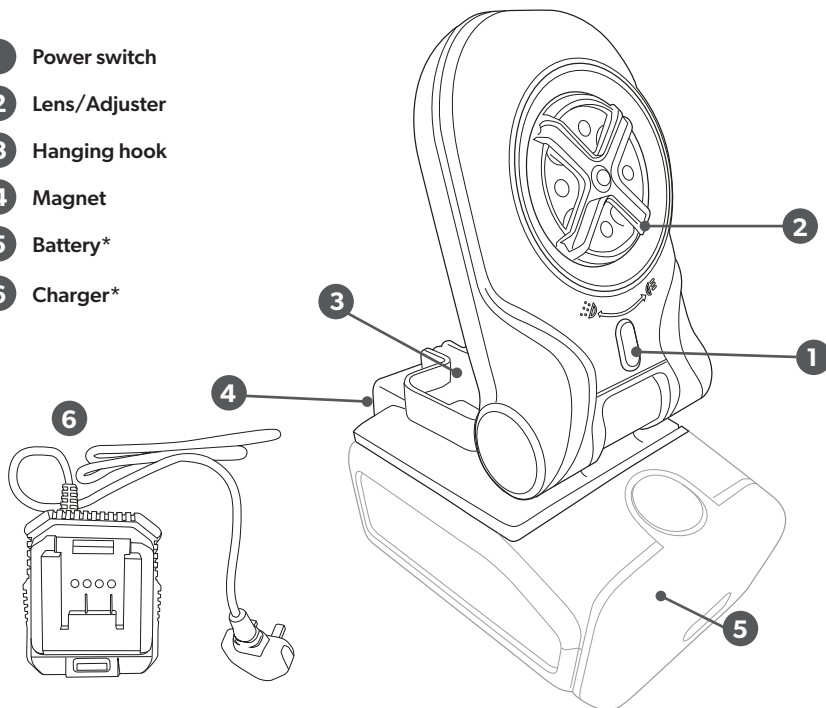

* Battery and charger not included with all model versions

Installing and removing the battery

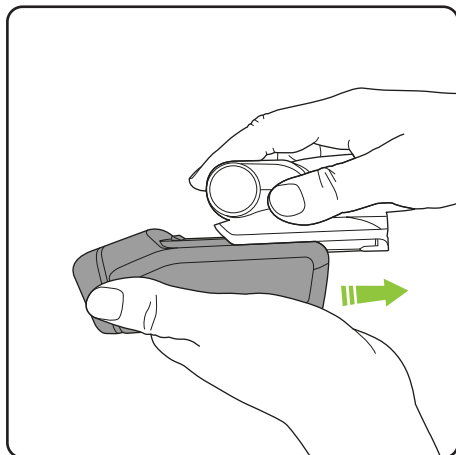

To install, simply insert the battery pack.

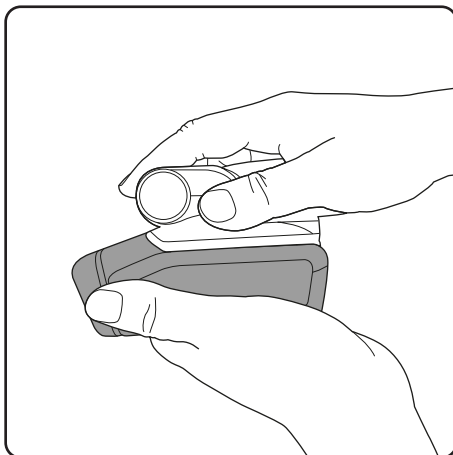

Make sure the latch on the battery snaps in place and battery pack is secured to the tool.

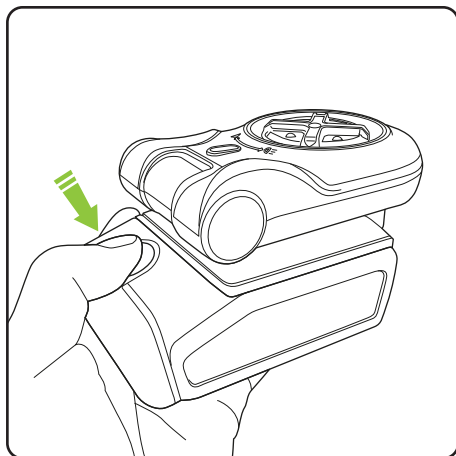

To remove, depress the latch...

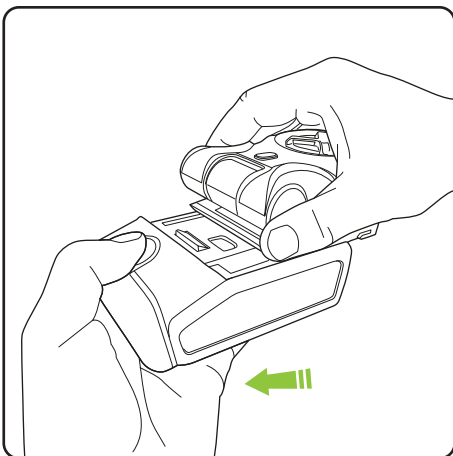

...and pull out the battery pack.

Adjusting the position of the light

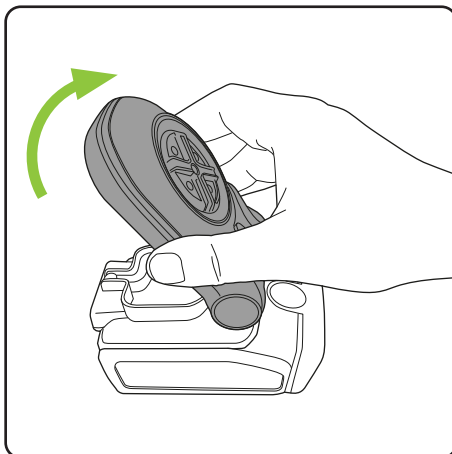
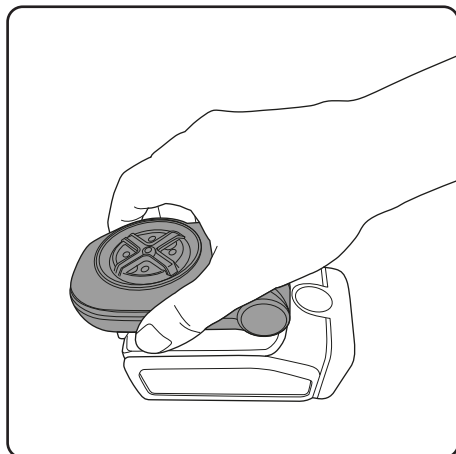

The light can be positioned through 180°

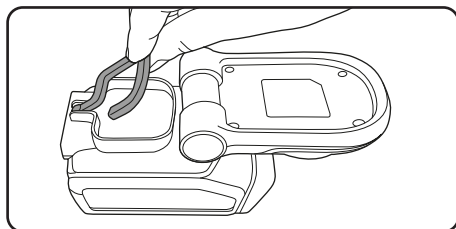
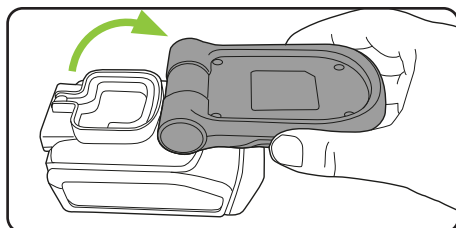

Fold the lamp fully forward to find the hanging hook. This can be flipped out.

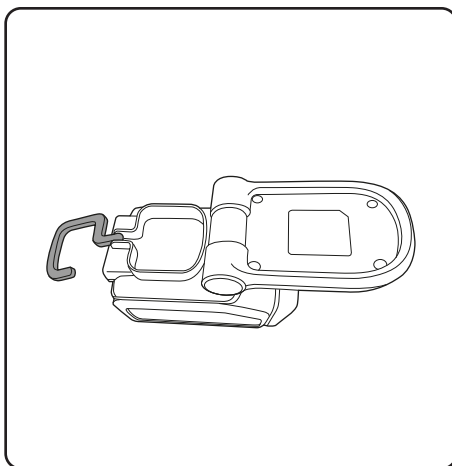

Once the hook has been deployed the light can be angled accordingly.

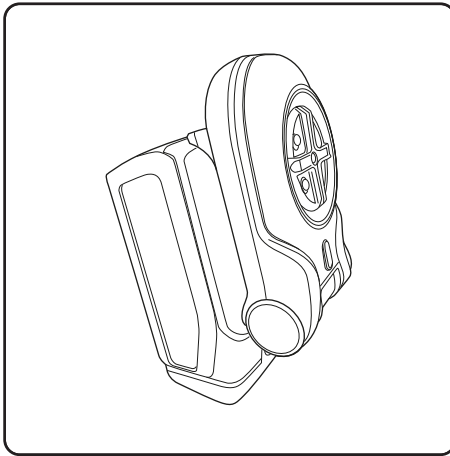

The lamp can also be sat upright

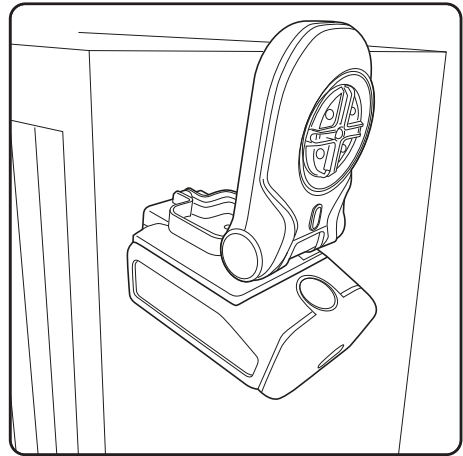

The magnet can be used to hold the light onto steel items.

Operation

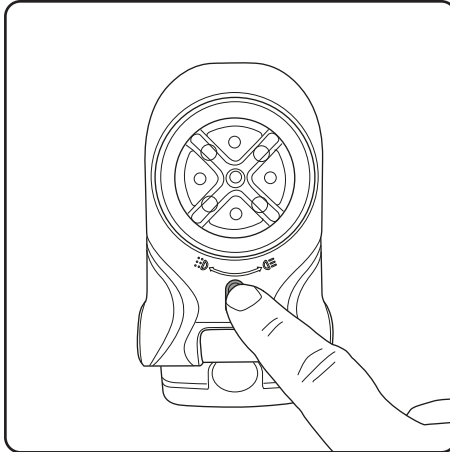

To switch on press the button. The light will power on with full brightness. Press a second time for power saving mode, and a third time to switch off.

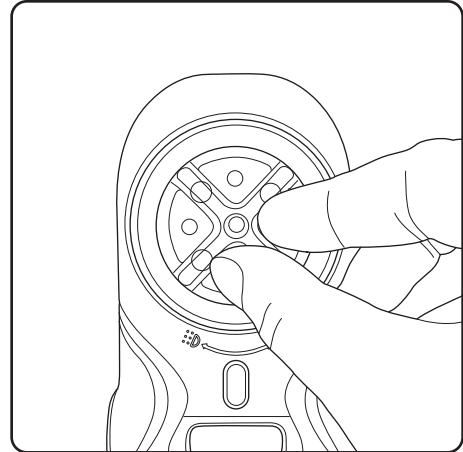

There is an adjuster on the lens to turn the beam from wide to narrow.

WARNING:

Do not shine the light directly into your own or anyone else's eyes.

Charging the battery

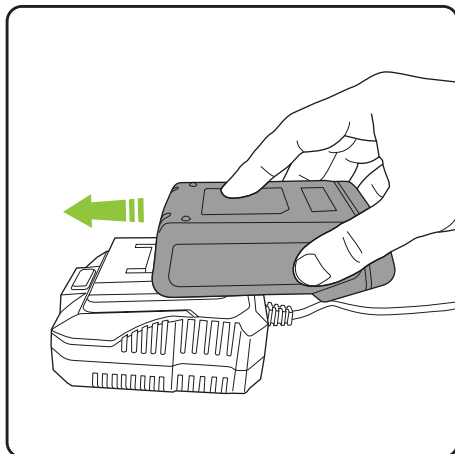

To charge the battery, line up the slot of the battery with the slot of the charger and slide into place. Plug the charger into a mains power socket.

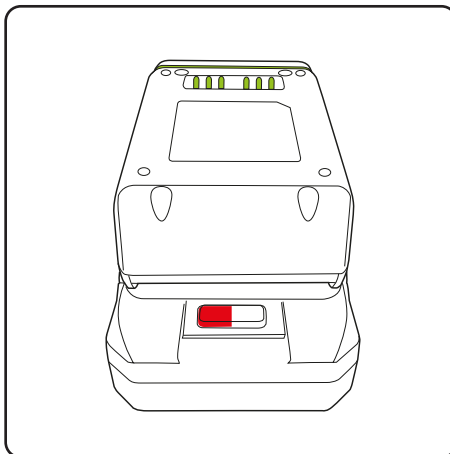

When charging the charger light will be red and the battery lights will pulse green.

WARNING:

Allow battery to cool down before charging if the battery is hot after continuous use.

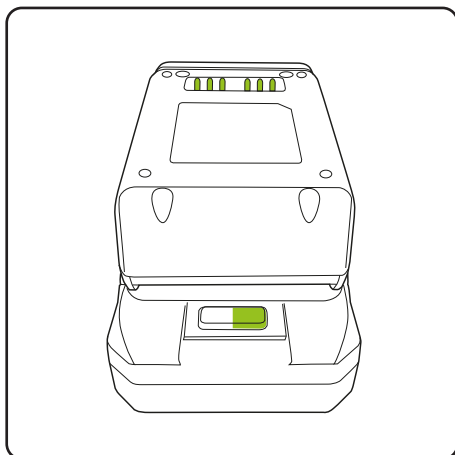

When fully charged the charger light and the battery lights will be green. Switch the charging stand off at the socket to optimise battery life.

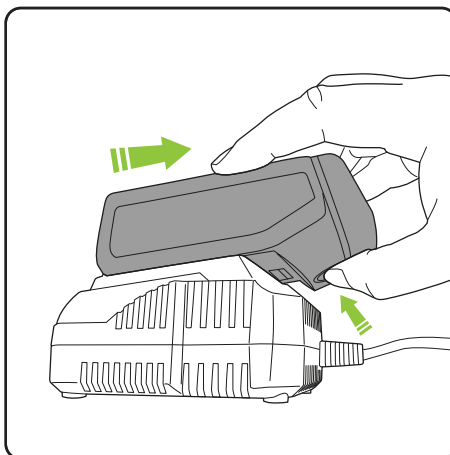

Press the latch and pull to remove the battery from the charger.

Battery state of charge indicator

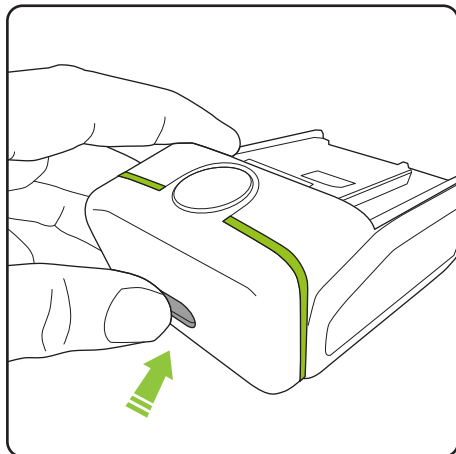

The state of charge of the battery can be checked by pressing the button. The green lights will indicate the level of charge.

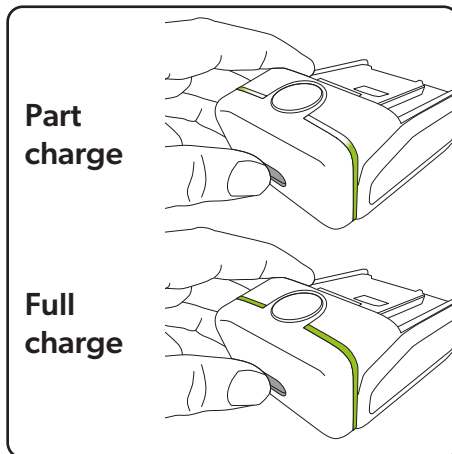

If the battery is fully discharged the green lights will flash for 10 seconds.

Product Care

Your product requires very little care and maintenance.

- Wipe clean with a dry cloth. Do not use water, solvents, or polishes to clean the product.
- Do not use abrasive materials to clean the product, and do not immerse it in water.
- Store in a secure, dry place, out of reach of children. Do not expose to moisture or wet conditions.
- To maintain optimum battery life store the battery in clean, dry conditions, within a recommended temperature range of 0 - 25°C. Do not store the battery in areas of high temperature above 25°C. Do not store near a source of heat or where exposed to direct sunlight.
- When the battery has fully charged, switch the charging stand off at the wall socket. and remove the battery. This will optimise the battery life.
- If the product will be stored for longer periods of time without use it is recommended to fully charge the battery before storage to help maintain its condition and life.

Safety warning for work-Light

This is not a toy; children should not be permitted to use it.

All electronic parts are fixed and do not open or attempt to make any changes unless a qualified electrician.

Do not attempt to replace or change the LED lights. If the protective glass is cracked or broken, it must be replaced before the light can be used again.

Troubleshooting

The product isn't working	The battery may have cut out due to excessive use to prevent overheating. Allow the product to cool down before re-using.
The product is getting hot	During intensive use, this is normal, but it is advisable to allow the product to cool down regularly to prevent damage of the motor.
The battery heats up during use	This is normal. Allow the battery to cool down regularly to prevent damage of the battery.
The battery and charger heat up during charging	This is normal. It is advisable to remove the battery from the charger once it is fully charged.

Product support

If these initial tips do not solve your problem we please visit our support area where you can find troubleshooting help including online manuals, FAQs and how-to-videos, as well as genuine spares and replacement parts compatible with your product.

Visit: www.gtech.co.uk/support



Online



Live chat support



us-support@gtech.co.uk



How to Videos

TECHNICAL SPECIFICATION

Voltage	DC 20V Max
Work Time:	Max 12 hrs
Output power	5 Watts
Brightness	300 Lumens High 150 Lumens Low

WARRANTY – REGISTRATION



If you purchased directly from Gtech, your details are already registered and your 2-year warranty will start automatically.

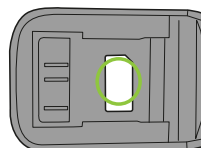

If you purchased from an authorised Gtech retailer, please register your warranty within 3 months. You will need to provide proof of purchase to support any claim(s) against your warranty.

WARRANTY – TERMS AND CONDITIONS

If your product is within its warranty and has a fault that cannot be resolved from the troubleshooting section or online support, please do the following:

- Contact the Gtech Customer Care Team at us-support@gtech.co.uk
- If your fault can be resolved by a replacement part, this will be sent to you free of charge.
- Following troubleshooting, if your product needs to be replaced, we will arrange collection of your faulty product for inspection, and delivery of a replacement product free of charge.

Your product is guaranteed against material or manufacturing faults for 2 years from the date of purchase (or the delivery date if this is later) subject to the following terms and conditions:

SUMMARY

The guarantee becomes effective at the date of purchase (or the date of delivery if this is later). If a product is repaired or replaced during the warranty period, the warranty period is not started again.

- You must provide proof of delivery/ purchase before any work can be carried out on the product. Without this proof, any work carried out will be chargeable. Please keep your receipt or delivery note.
- All work will be carried out by Gtech or its authorised agents.
- Any parts which are replaced will become the property of Gtech.
- The repair or replacement of your product is under guarantee and will not extend the period of guarantee.
- The guarantee provides benefits which are additional to and do not affect your statutory rights as a consumer.

WHAT ISN'T COVERED

Gtech does not guarantee the repair or replacement of a product as a result of:

- Normal wear and tear (e.g. drive belt, brush bar, batteries) .
- Use of consumables (e.g dust bags and cartridges)
- Accidental damage, faults caused by negligent use or lack of care and maintenance, misuse, neglect, careless operation or handling of the product which is not in accordance with operating manual.
- Blockages. Please refer to the operating manual for details of how to unblock your product.
- Use of the product for anything other than the normal domestic household purposes.
- Use of parts and accessories which are not Gtech genuine components.
- Faulty installation (except where installed by Gtech)
- If it is modified in any way.
- Repairs or alterations carried out by parties other than Gtech or its authorised agents.
- Purchasing your product from an unofficial third party (i.e not from Gtech or an official Gtech retailer.
- If you are in doubt as to what is covered by your guarantee, please contact us-support@gtech.co.uk

International orders are subject to a delivery charge for both faulty and non faulty products.

Product Recycling

Many of the electrical items that are thrown away can be repaired or recycled, saving natural resources and helping to protect the environment.

Gtech products are marked with the  symbol indicating they can be recycled, and are covered by legislation for Waste Electrical and Electronic Products (2012/19/EU)

When the product has reached the end of its life both it and the Li-Ion battery it contains should not be disposed of with general household waste. The battery should be removed from the product and both should be disposed of separately at a recognised recycling centre.

Recycling electrical products and batteries is free at your local recycling centre.

To find your nearest centre and discover how easy it is to recycle electrical products visit

www.recycle-more.co.uk

Alternatively contact your local council or civic amenity site.

**UK
CA**

CE



FOR DOMESTIC USE ONLY

Notes

Notes



Grey Technology Limited

Brindley Road, Warndon, Worcester WR4 9FB, UK

email: support@gtech.co.uk

telephone: 08000 308 794

www.gtech.co.uk

5772 240822